

NOTICE TO CONTRACTORS

1. SPECIFICATIONS: ALL WORK SHALL CONFORM TO THE LATEST EDITION AND SUPPLEMENTS OF "THE STANDARD SPECIFICATIONS FOR PUBLIC WORKS CONSTRUCTION" (GREENBOOK), AND THE CORRESPONDING "ADDITIONS AND AMENDMENTS TO THE LATEST EDITION OF THE STANDARD SPECIFICATIONS FOR PUBLIC WORKS CONSTRUCTION" (BROWN BOOK).
2. THIS IMPROVEMENT CONSISTS OF WORK CALLED FOR ONLY ON THIS PLAN.
3. STANDARD PLANS FOR THIS PROJECT:
- | | |
|-----------------------------------|---------|
| HOUSE CONNECTION SEWERS | S-110-1 |
| SEWER MANHOLES - GENERAL | S-140-0 |
| PRECAST CONCRETE SEWER MANHOLES | S-142-0 |
| PIPE LAYING IN TRENCHES | S-251-1 |
| MANHOLE FRAME AND COVER 27-INCH | S-282-1 |
| SYMBOLS FOR CONSTRUCTION NOTES | S-627-0 |
| ADVANCE CONSTRUCTION NOTICE SIGNS | S-791-1 |
4. INSPECTION: ALL WORK AND MATERIALS ARE SUBJECT TO INSPECTION PURSUANT TO SECTION 2-11 OF THE STANDARD SPECIFICATIONS. CALL (213) 580-5080 (METRO) OR (818) 374-1188 (VALLEY) BEFORE NOON OF THE WORKING DAY BEFORE INSPECTION IS REQUIRED.
5. THE CONTRACTOR, IN CONFORMANCE WITH THE LOS ANGELES CITY ORDINANCE NO. 150,478 SHALL POTHOLE EXISTING SUBSURFACE INSTALLATIONS CARRYING UNSTABLE SUBSTANCES TO DETERMINE THEIR LOCATIONS AND ELEVATIONS BEFORE COMMENCING EXCAVATION.
6. "UNDERGROUND SERVICE ALERT": BEFORE COMMENCING ANY EXCAVATION, THE CONTRACTOR SHALL OBTAIN AN UNDERGROUND SERVICE ALERT (USA) INQUIRY I.D. NUMBER BY CALLING (800) 227-2800. TWO WORKING DAYS SHALL BE ALLOWED AFTER THE I.D. NUMBER IS OBTAINED AND BEFORE THE CONTRACTOR STARTS THE EXCAVATION WORK SO THAT UTILITY OWNERS CAN BE NOTIFIED. IF THE UTILITY OWNER IS THE CITY OF LOS ANGELES, A CONFIRMATION NUMBER INDICATING THE CITY HAS BEEN NOTIFIED SHALL BE OBTAINED BY USA AND/OR THE CONTRACTOR FROM THE APPROPRIATE CITY DEPARTMENT. THE I.D. NUMBER TOGETHER WITH THE DATE ACQUIRED SHALL BE REPORTED TO THE BUREAU OF CONTRACT ADMINISTRATION WHEN CALLING FOR INSPECTION. I.D. NUMBERS WILL NOT BE GIVEN MORE THAN 10 DAYS BEFORE STARTING EXCAVATION WORK.
7. AT LEAST THIRTY (30) DAYS BEFORE THE START OF CONSTRUCTION THE CONTRACTOR / ENGINEER SHALL CONTACT BUREAU OF STREET SERVICES, COORDINATING SECTION AT (213) 485-5691 TO VERIFY THAT THERE IS NO PROPOSED PROJECT IN THIS AREA.
8. NOTIFICATIONS: AT LEAST TEN (10) DAYS BEFORE THE START OF CONSTRUCTION, THE CONTRACTOR SHALL NOTIFY, IN WRITING, ABUTTING PROPERTY OCCUPANTS OF THE PROPOSED CONSTRUCTION START DATE. A COPY OF SAID WRITTEN NOTIFICATION SHALL BE PROVIDED TO THE INSPECTOR FOR APPROVAL BEFORE THEY ARE DISTRIBUTED TO THE OCCUPANTS OF THE ABUTTING PROPERTY.
9. "ADVANCE CONSTRUCTION NOTICE SIGNS": IN ADDITION TO SIGNS REQUIRED BY THE PROVISIONS OF THE "WORK AREA TRAFFIC CONTROL HANDBOOK" (WATCH), LATEST EDITION, FURNISH AND PLACE SIGNS FOR GIVING ADVANCE NOTICE TO MOTORISTS OF TRAFFIC DISRUPTION AS PART OF THIS PROJECT IN ACCORDANCE WITH STANDARD PLAN S-791-1.
10. TRAFFIC CONTROL SHALL BE IN ACCORDANCE WITH THE LATEST EDITION OF THE WORK AREA TRAFFIC CONTROL HANDBOOK (WATCH) ADOPTED BY THE BOARD OF PUBLIC WORKS OF THE CITY OF LOS ANGELES.
11. CONSTRUCTION STAKES FOR CURB AND LONGITUDINAL GUTTER, WITH GRADE LESS THAN 0.50%, SHALL BE SET 12.5 FEET ON THE CENTER.
12. REMOVALS:
- REMOVE ALL EXISTING IMPROVEMENTS THAT INTERFERE WITH THE CONSTRUCTION OF THIS PROJECT.
 - ALL UTILITIES SHALL BE REMOVED OR RELOCATED BY OTHERS.
13. IN ADDITION TO THE CONSTRUCTION OF PAVEMENT SHOWN HEREON, WORK REQUIRED UNDER THIS PLAN WILL ALSO INCLUDE THE CONSTRUCTION OF PERMANENT TRENCH RESURFACING IN ALL AREAS WHERE UTILITY LINES HAVE BEEN INSTALLED TO SERVE THIS DEVELOPMENT. CONDITIONS OF TRENCH BACKFILL AND RESURFACING SHALL BE AS SPECIFIED ON THE EXCAVATION PERMIT.
14. REPAIR AND/OR REPLACE ANY EXISTING BROKEN OR OFF-GRADE PAVEMENT, CONCRETE CURB, GUTTER OR SIDEWALK IMMEDIATELY ADJACENT TO OR WITHIN THE AREA OF THIS IMPROVEMENT SATISFACTORY TO THE CITY ENGINEER.
15. SURVEY MONUMENT PRESERVATION IS REQUIRED AND SHALL INCLUDE SUBMITTAL OF PRE AND POST CONSTRUCTION SURVEY MONUMENT TIES TO THE ENGINEER, AS NOTED BY SECTION 2-9.3 OF THE "BROWN BOOK".
16. IMPORTANT NOTICE: ALL REQUIRED PUBLIC IMPROVEMENTS MUST BE COMPLETED BEFORE A TEMPORARY CERTIFICATION OF OCCUPANCY OR A CERTIFICATE OF OCCUPANCY WILL BE ISSUED FOR THIS PROJECT PER ORDINANCE NO. 165081.
17. RESURFACE SEWER TRENCH IN ACCORDANCE WITH THE SANTANDARD SPECIFICATIONS FOR PUBLIC WORKS CONSTRUCTION (GREENBOOK).
18. TRAFFIC LANE REQUIREMENTS:
- SUPERIOR STREET
MAINTAIN ONE LANE OF TRAFFIC IN EACH DIRECTION AT ALL TIMES.
- AURA AVENUE
MAINTAIN LOCAL AND EMERGENCY ACCESS AT ALL TIMES.
FOLLOW THE 2006 "WATCH" MANUAL AND THE MUTCD.
THE CONTRACTOR SHALL NOTIFY LADOT'S SPECIAL TRAFFIC CONTROL DIVISION AT (213) 485-2298 FIVE (5) WORK DAYS PRIOR TO THE START OF CONSTRUCTION FOR THE POSTING OF TEMPORARY "TOW-AWAY NO STOPPING" SIGNS ADJACENT TO THE WORK AREA AS NEEDED TO COMPLY WITH THE REQUIREMENTS ABOVE.
FOR TRAFFIC RELATED QUESTIONS DURING CONSTRUCTION, CONTACT WEST VALLEY DISTRICT OFFICE, LADOT AT (818) 756-8784.

CONSTRUCTION NOTES

- ☐ CONSTRUCT ☐ REMODEL EXIST.
- ☐ EXISTING ☐ REMOVE & CONST.
- ☐ REMOVE ☐ WORK BY OTHERS

ONLY IF USED

INDEX TO SHEETS

SHT NO	PLANS OF	FROM	TO
1	TITLE SHEET		
2	SEWER AURA AVENUE	SUPERIOR STREET	215' N/O SUPERIOR STREET

SEWER LEGEND:

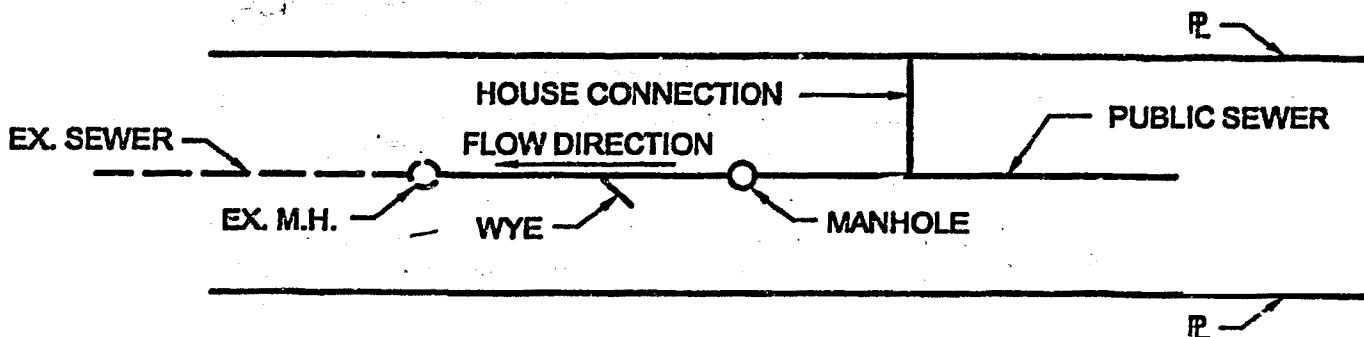

PARTICIPATION NOTE:

THE LINE SHOWN THUS: --- HEREON INDICATES THE BOUNDARY OF ALL PROPERTY WHICH IS PARTICIPATING IN THE CONSTRUCTION COST OF THE SEWER SHOWN HEREON.

Nancy Cartwright
PERMITTEE: NANCY CARTWRIGHT

Dec. 12, 2007
DATE

Make sure notes are current

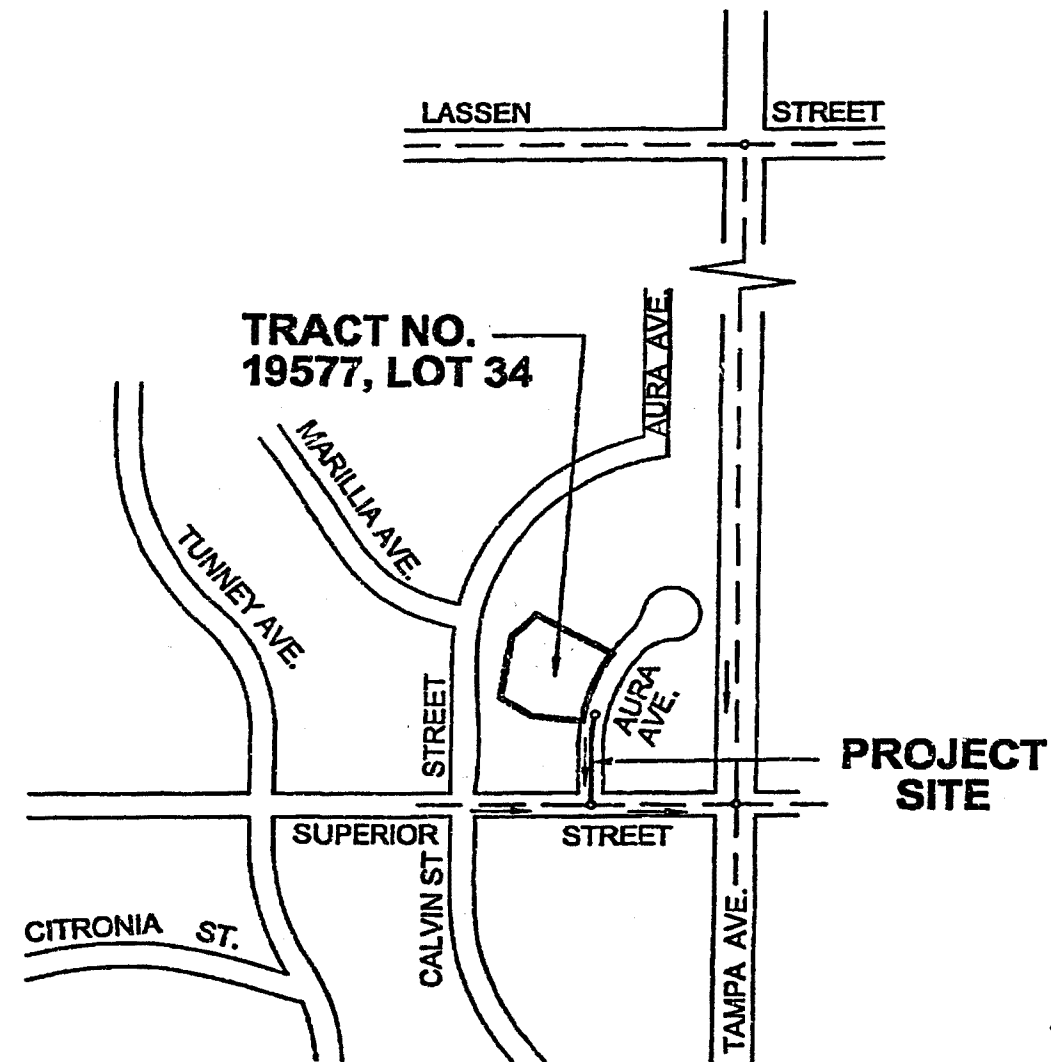

KEY MAP

SCALE: 1"=400'

0' 200' 400' 800'

GRAPHIC SCALE

"AS-BUILT"

BUREAU OF ENGINEERING	
DATE: 12/12/07	INDEX NO. D-33535
ADDED H.O. STA. 1+00 PER 1/4" = 1' H.P.D. 1/4" = 1'	B - PERMITS 204561
20 H.S.T. 1	
WORK ACCEPTED	
APPROVALS: DATE: BY:	
D.O.T. 1/10/08	
SEWERS 1/10/08	
SANITATION 1/10/08	
DEPARTMENTAL APPROVALS ON FILE IN THE ELECTRONIC VAULT	
DEPARTMENT OF PUBLIC WORKS	
GARY LEE MOORE, P.E. CITY ENGINEER	
ACCEPTED BY: <i>Bill B...</i>	DATE: 1-2-08
PLAN CHECKER: <i>Mike...</i>	DATE: 2-22-08
DIVISION / DISTRICT ENGINEER	
CITY OF LOS ANGELES	
VERTICAL CONTROL: BN # 07-20325, NGVD 1929, 180' ADJ	INDEX, NOTES AND KEY MAP
HORIZONTAL CONTROL:	PROJECT: AURA AVENUE NW/WS 195'
SHEET TITLE:	TO 329' N/O SUPERIOR STREET
ADDRESS: 9723 AURA AVENUE	LOS ANGELES, CA.
PROJECT NO.	
DRAWING NO. 1	
SHEET 1 OF 2 SHEETS	

THE CITY OF LOS ANGELES OR ITS OFFICERS OR AGENTS SHALL NOT BE RESPONSIBLE FOR THE ACCURACY OR COMPLETENESS OF ELECTRONIC COPIES OF THIS PLAN SHEET.

REVISION DATES
(DESIGN STAGE ONLY)

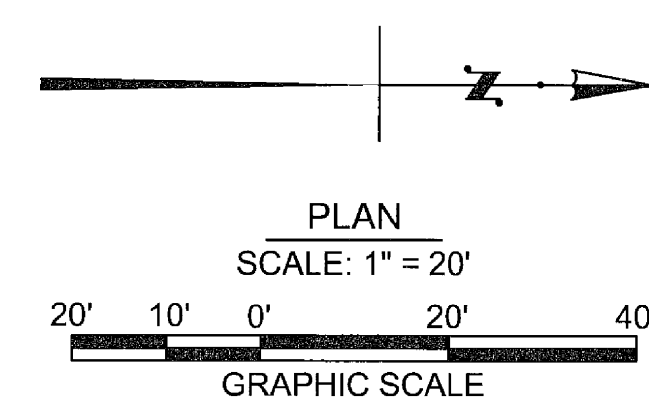
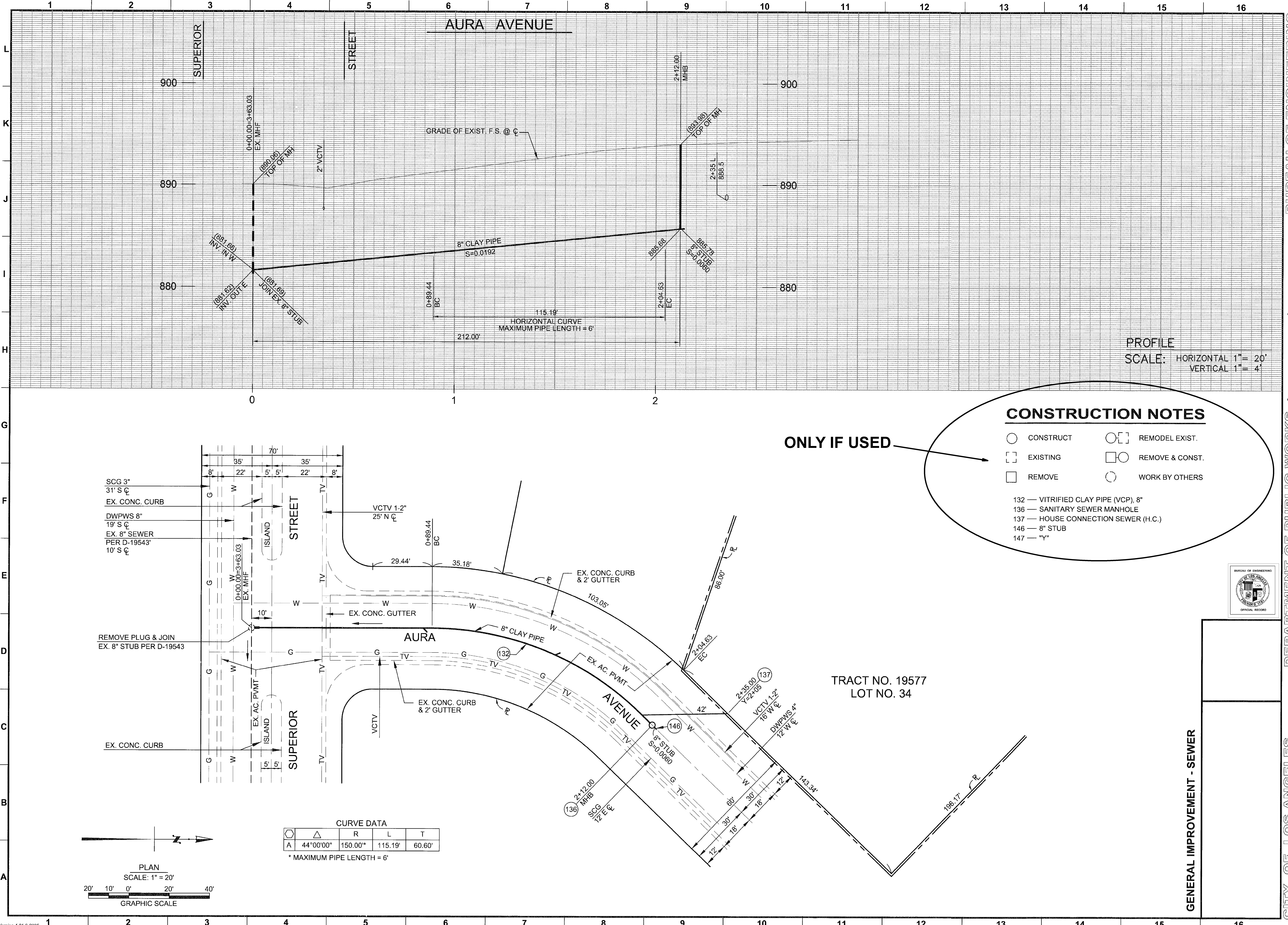

CURVE DATA				
	R	L	T	
A	44°00'00"	150.00*	115.19'	60.60'

* MAXIMUM PIPE LENGTH = 6'

ONLY IF USED

CONSTRUCTION NOTES

- CONSTRUCT
- ◻ REMODEL EXIST.
- ◻ EXISTING
- ◻○ REMOVE & CONST.
- ◻ REMOVE
- WORK BY OTHERS

- 132 — VITRIFIED CLAY PIPE (VCP), 8"
- 136 — SANITARY SEWER MANHOLE
- 137 — HOUSE CONNECTION SEWER (H.C.)
- 146 — 8" STUB
- 147 — "Y"

PROFILE
SCALE: HORIZONTAL 1" = 20'
VERTICAL 1" = 4'

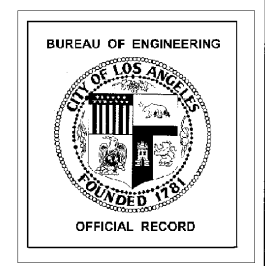

GENERAL IMPROVEMENT - SEWER

REVISIONS

DATE BY

NO

REVISIONS

APPROVAL

OFFICE: VALLEY DISTRICT

CHECKED BY: BILL BRIGGS

DATE: 11/2/08

WORK ACCEPTED

SERIAL NO.

INDEX NO. D-33535

B - PERMITS

BD/BC 204581

BUREAU OF ENGINEERING

DESIGN GROUP

Richard Garcia, P.E.

ENGINEER

DESIGNED BY

DRAWN BY

CHECKED BY

APPROVED BY

PROJECT TITLE

SEWER PLAN AND PROFILE

AURA AVENUE NW/S 195'

TO 329' N/O SUPERIOR STREET

9723 AURA AVENUE

LOS ANGELES, CA

PROJECT NO.

DRAWING NO.

2

CITY OF LOS ANGELES

DEPARTMENT OF PUBLIC WORKS

BUREAU OF ENGINEERING

VERTICAL CONTROL

HORIZONTAL CONTROL

BM 7.07-20325, NGVD 1929, 1980 ADJ

TRACT NO. 19577

LOT NO. 34